



Carisbrooke Road | | Newport | PO30 1DQ

Asking Price £158,000



Carisbrooke Road |  
Newport | PO30 1DQ  
Asking Price £158,000

Welcome to this charming house located on Carisbrooke Road in Newport. This delightful property, built in 1870, offers a perfect blend of character and modern living. With a total area of 706 square feet, it features two inviting reception rooms, ideal for entertaining guests or enjoying quiet evenings at home.

The house comprises two comfortable bedrooms, providing ample space for relaxation, along with a well-appointed bathroom. This home is perfect for those seeking a quaint yet functional living space in a desirable location.

- 2 RECEPTION ROOMS
- 2 BEDROOMS
- CHARMING 1870s HOUSE
- LOCATED ON CARISBROOKE ROAD
- CLOSE TO NEWPORT AMENITIES

**Living Room**  
11'9" x 12'8" (3.58 x 3.85)

**Dining Room**  
11'3" x 12'7" (3.44 x 3.84)

**Kitchen**  
11'3" x 8'8" (3.43 x 2.65)

**Hallway**  
11'1" x 2'6" (3.39 x 0.76)

**Bathroom**  
8'4" x 5'3" (2.53 x 1.59)

**Bedroom 1**  
11'8" x 12'7" (3.55 x 3.83)

**Bedroom 2**  
8'8" x 9'2" (2.64 x 2.8)

Rear Garden

Outbuilding

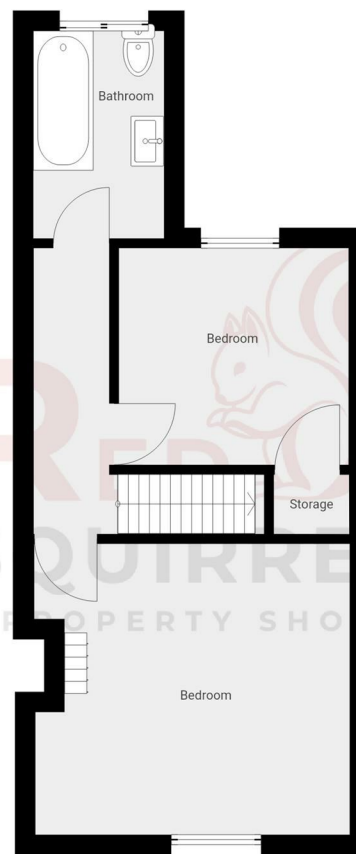

Energy Efficiency Rating		Current	Potential
<i>Very energy efficient - lower running costs</i>			
(92 plus)	A		
(81-91)	B		
(69-80)	C		
(55-68)	D		
(39-54)	E		
(21-38)	F		
(1-20)	G		
<i>Not energy efficient - higher running costs</i>			
<b>England &amp; Wales</b>		EU Directive 2002/91/EC	

Council Tax Band **B**  
EPC Rating

3 Langely Court Pyle Street  
Newport  
Isle of Wight  
PO30 1LA  
01983 521212

enquiries@redsquirrelpropertyshop.co.uk  
www.redsquirrelpropertyshop.co.uk

THIS FLOOR PLAN IS PROVIDED WITHOUT WARRANTY OF ANY KIND. SENSOPHA DISCLAIMS ANY WARRANTY INCLUDING, WITHOUT LIMITATION, SATISFACTORY QUALITY, ACCURACY OF DIMENSIONS.